

NOTES:

1. CHANGE OF MATERIAL IS NOT PERMITTED UNLESS APPROVED IN WRITING BY FETCO PERSONNEL.
2. DRAWING TO BE INTERPRETED IN ACCORDANCE WITH THE CURRENT REVISION OF ASME Y14.5M.
3. TSI TO BE INTERPRETED AS THEORETICAL SHARP INTERSECTION.
4. PARTS SHALL BE FREE OF ALL CONTAMINANTS INCLUDING GREASE, DIRT, MACHINING OIL AND OTHER CONTAMINANTS.
5. PARTS SHALL BE PACKAGED IN A MANNER TO PREVENT SCRATCHING, BOWING OR OTHER DAMAGE DURING SHIPMENT.

REVISIONS

REV	DATE	ECO NO	DESCRIPTION	BY:
A	12/05/2013	N/A	ORIGINAL	E.FORONDA

A

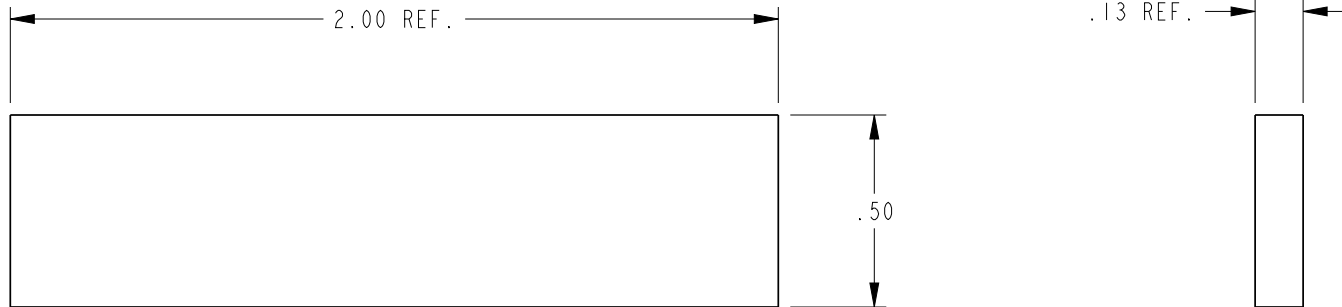

PROPRIETARY AND CONFIDENTIAL.
 THE INFORMATION CONTAINED IN THIS DRAWING IS THE SOLE PROPERTY OF FETCO.
 ANY REPRODUCTION IN PART OR AS A WHOLE WITHOUT THE WRITTEN PERMISSION OF FETCO IS PROHIBITED.

TOLERANCES UNLESS OTHERWISE SPECIFIED		FETCO ® FOOD EQUIPMENT TECHNOLOGIES COMPANY 600 ROSE ROAD, LAKE ZURICH, IL 60047, USA PHONE: (800) 338-2699 FAX: (847) 719-3001 E-MAIL: engineering@fetco.com www.fetco.com	
ALL DIMENSIONS IN INCHES		DRAWING NAME: R-1 FOAM INSULATION TAPE, 2" WIDE x 1/2" LG.	
ALL DECIMAL ± .005" ANGULAR ± 1/2°	THIRD-ANGLE 	CREATED BY: E.FORONDA	DATE 12/05/2013
		DRAWING BY: E.FORONDA	SCALE 2.000
		APP'D BY: AS	DRAWING NO 1022.00076.00
		SHEETS 1 of 1	REVISION A
MATERIAL R-1 FOAM INSULATION (1097.00134.00)		GAUGE N/A	FINISH N/A