

SECTION A-A

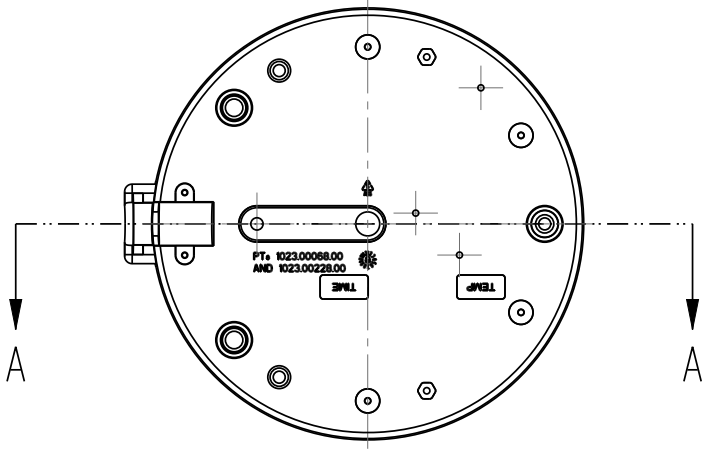

REVISIONS

REV	DATE	ECO NO	DESCRIPTION	BY:	D
A	10/15/2014	N/A	ORIGINAL	MK	
B	05/19/2015	N/A	PART IDENTIFICATION ADDED ON BOTTOM	E.FORONDA	
C	05/19/2016	ECO 00624	MOLD MODIFICATION FOR P/N1023.00068.00	E.FORONDA	
D	12/12/2016	N/A	CHANGED DWG. PER CHANGES ON 1023.00068.00	E.FORONDA	

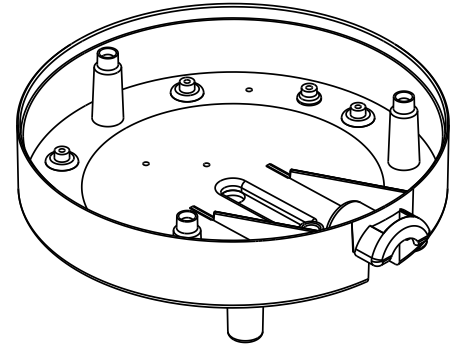

THIS PART HAS THE SAME DIMENSIONS AS P/N 1023.00068.00
DIFFERENT IS MATERIAL

PROPRIETARY AND CONFIDENTIAL.
THE INFORMATION CONTAINED IN THIS DRAWING IS THE SOLE PROPERTY OF FETCO.
ANY REPRODUCTION IN PART OR AS A WHOLE WITHOUT THE WRITTEN PERMISSION OF FETCO IS PROHIBITED.

TOLERANCES UNLESS OTHERWISE SPECIFIED		FETCO FOOD EQUIPMENT TECHNOLOGIES COMPANY 600 ROSE ROAD, LAKE ZURICH, IL 60047, USA PHONE: (800) 338-2699 FAX: (847) 719-3001 E-MAIL: engineering@fetco.com www.fetco.com	
ALL DIMENSIONS IN INCHES		DRAWING NAME: BOTTOM GREY, L3D-15/20, INNOTHERM	
ALL DECIMAL ± .005" ANGULAR ± 1/2°	THIRD-ANGLE	CREATED BY: MK	DATE 10/15/2014
		DRAWING BY: MK	SCALE 0.250
		APP'D BY: LMW	SHEETS 1 of 1
MATERIAL 1097.00077.00 & 1097.00110.00	GAUGE N/A	DRAWING NO 1023.00228.00	
		REVISION D	
		FINISH N/A	