

NOTES:

1. DRAWING TO BE INTERPRETED IN ACCORDANCE WITH THE CURRENT REVISION OF ASME Y14.5M.
2. TSI TO BE INTERPRETED AS THEORETICAL SHARP INTERSECTION
3. PARTS SHALL BE FREE OF ALL CONTAMINANTS INCLUDING GREASE, DIRT, MACHINING OIL AND OTHER CONTAMINANTS.
4. PARTS SHALL BE PACKAGED IN A MANNER TO PREVENT SCRATCHING, BOWING OR OTHER DAMAGE DURING SHIPMENT.

ADDITIONAL PARTS REQUIRED BUT NOT PICTURED	
PART NUMBER	QUANTITY
1066.00002.00	20
1029.00005.00	10
1064.00005.00	3
1064.00004.00	1

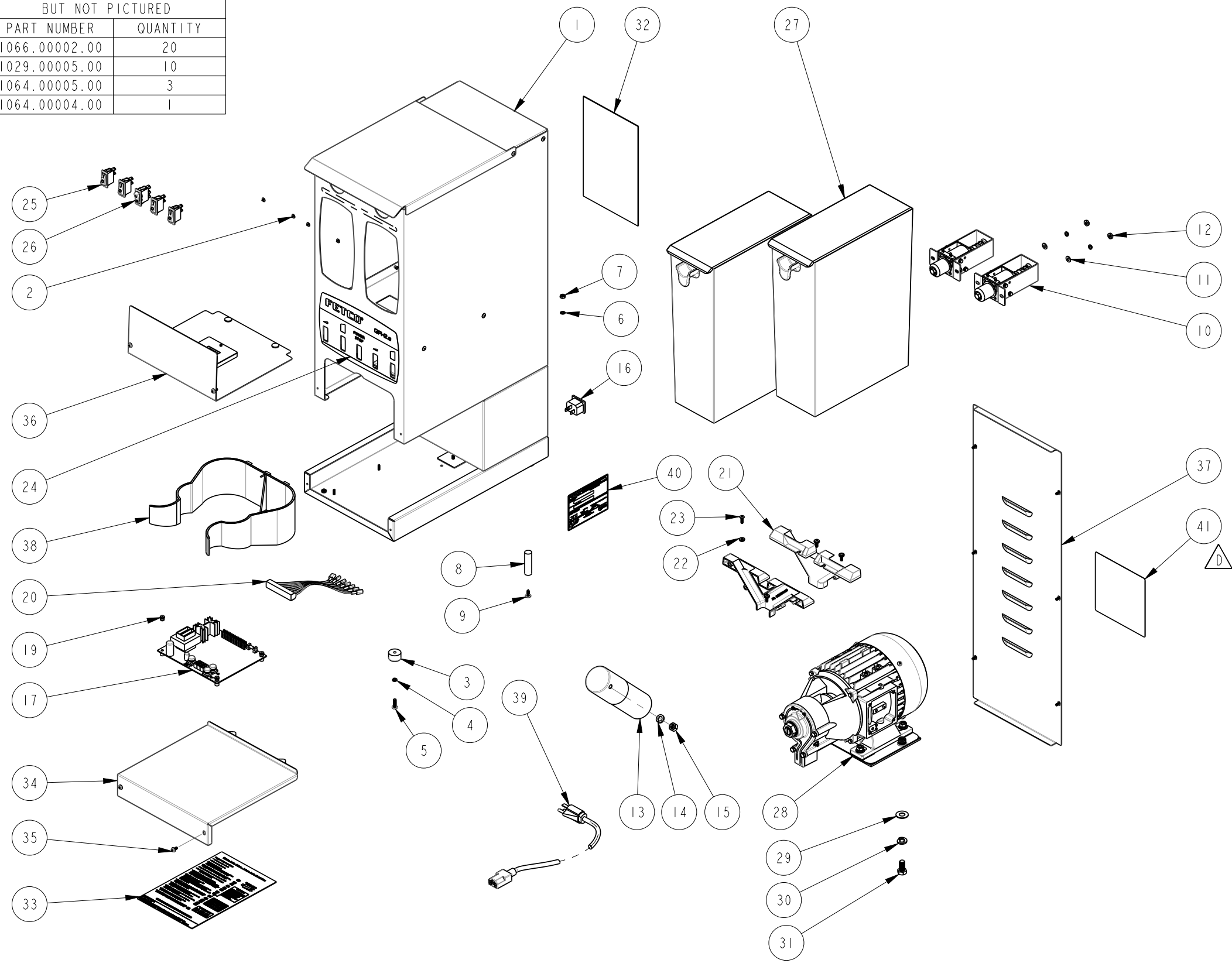

REVISIONS

REV	DATE	ECO NO	DESCRIPTION	BY:	D
A	12/15/2009	N/A	ORIGINAL		DP
B	10/29/2013	N/A	UPDATE TO STANDARD; REM'D. SHT. 3-4		E.FORONDA
C	08/18/2015	N/A	DRW UPDATED WITH CTR. BOARD INFO		DK
D	3/22/2017	N/A	ADDED ITEM 41, WARNING LABEL ITEM 40 WAS 1042.00004.00		E.FORONDA



41	1	1046.00035.00	LABEL, WARNING "TO REDUCE RISK OF ELECTRIC SHOCK OR FIRE"
40	1	1043.00036.00	TEMPLATE, SN LABEL, FETCO PRODUCTS
39	1	1063.00003.00	CORD, POWER, AMERICAN, 120VAC, 13A, 6FT LG.
38	1	1023.00041.00	HOLDER, BREW BASKET, GR-1/2
37	1	1001.00035.00	COVER, REAR, GR-2
36	1	1102.00023.00	COVER, GRINDER SERVICE ASSEMBLY, W/O RAILS
35	10	1082.00033.00	SCREW, PAN HD PHIL. MACH., W/DUAL ACT WASHER, #6-32x3/8LG.
34	1	1112.00023.00	BASE COVER WELDMENT, GR/GRF
33	1	1046.00009.00	LABEL "GR PROGRAMMING"
32	1	1401.00007.00	WIRING DIAGRAM, UNIVERSAL, GR-2
31	2	1082.00032.00	SCREW, 3/8"-16 X 3/4" LG, HEX HEAD CAP
30	2	1083.00020.00	WASHER, 3/8" SCREW SIZE, SPRING LOCK
29	2	1083.00022.00	WASHER, 3/8" SCREW SIZE, FLAT
28	1	1102.00038.00	GRINDING MOTOR AND PLATE ASSY, 120V/60Hz
27	2	1102.00033.00	HOPPER, ASSEMBLY, GRF-2.3
26	1	1058.00006.00	SWITCH, POWER ROCKER RED, ILLUMINATED 120V
25	4	1058.00007.00	SWITCH, START ROCKER, MOMENTARY, 250VAC
24	1	1045.00009.00	OVERLAY, GR-2.2 (OVAL)
23	4	1082.00017.00	SCREW, TRUSS HD. PHIL. MACHINE, # 6-32 X 1/2 LG.
22	4	1083.00010.00	WASHER, #10 SCREW W/NEOPRENE-BONDED SEAL
21	2	1023.00044.00	MANIFOLD, GR-2
20	1	1402.00010.00	ELECTRICAL HARNESS, GR 2.3
19	4	1029.00006.00	NUT, FINGER, #4-40 NYLON
18	1	1050.00003.00	SOFTWARE, GRINDERS, V 1.2
17	1	1108.00028.00	ASSY, BOARD CONTROL AND SOFTWARE, GR-1/2 100-120VAC
16	1	1065.00003.00	CONNECTOR, POWER INLET, 15A, 250VAC
15	1	1084.00018.00	NUT, HEX, M8 SCREW SIZE
14	1	1083.00025.00	WASHER, M8 SCREW SIZE, SPRING LOCK
13	1	1067.00001.00	CAPACITOR, 120VAC VERSION, 40uF, 450VAC, 50-60Hz
12	4	1084.00014.00	NUT, HEX, #10-32, MACHINE SCREW
11	4	1083.00026.00	WASHER, #10 SCREW SIZE, FLAT
10	2	1102.00034.00	SOLENOID ASSEMBLY, 120VAC, GR-2
9	1	1082.00018.00	SCREW, TRUSS HD. PHIL. SM, #8 X 1/2 LG.
8	1	1021.00005.00	ROD, VIBRATION DAMPENING, GR-2
7	1	1084.00006.00	NUT, 8-32 18-8 HEX MACHINE SCREW
6	1	1083.00011.00	WASHER, #8 SCREW SIZE, INTERNAL TOOTH LOCK
5	4	1082.00031.00	SCREW, #10-32 X 5/8", PAN HD PHIL, MACHINE
4	8	1083.00019.00	WASHER, #10 SCREW SIZE, SPRING LOCK
3	4	1073.00006.00	FOOT, GRINDER
2	4	1029.00009.00	FASTENER, 9/32" HEAD DIA X .165" LG, PUSH IN
1	1	1111.00011.00	BODY, WELDMENT, GR-2

ITEM NO	QTY	PART NO	DESCRIPTION
BILL OF MATERIALS			
TOLERANCES			
UNLESS OTHERWISE SPECIFIED			
ALL DIMENSIONS IN INCHES			
ALL DECIMAL ± .005" ANGULAR ± 1/2°			
THIRD-ANGLE			
MATERIAL N/A			
GAUGE N/A			
FINISH N/A			

**FETCO** FOOD EQUIPMENT TECHNOLOGIES COMPANY  
 600 ROSE ROAD, LAKE ZURICH, IL 60047, USA  
 PHONE: (800) 338-2699 FAX: (847) 719-3001  
 E-MAIL: engineering@fetco.com www.fetco.com

**GRINDER ASSEMBLY, GR-2.2, 120V**

CREATED BY: DP	DATE: 12/15/2009	DRAWING NO.:
DRAWING BY: DP	SCALE: 0.125	<b>1101.00033.00</b>
APP'D BY: AG	SHEETS: 1 of 2	REVISION: <b>D</b>

PROPRIETARY AND CONFIDENTIAL. THE INFORMATION CONTAINED IN THIS DRAWING IS THE SOLE PROPERTY OF FETCO. ANY REPRODUCTION IN PART OR AS A WHOLE WITHOUT THE WRITTEN PERMISSION OF FETCO IS PROHIBITED.

AT ASSEMBLY, POSITION OVERLAY AS SHOWN. ALIGN OVERLAY CUT-OUT OPENING HOLES, FROM THE SHEET METAL CUT-OUT HOLES AND ASSEMBLE SWITCHES AS SHOWN.

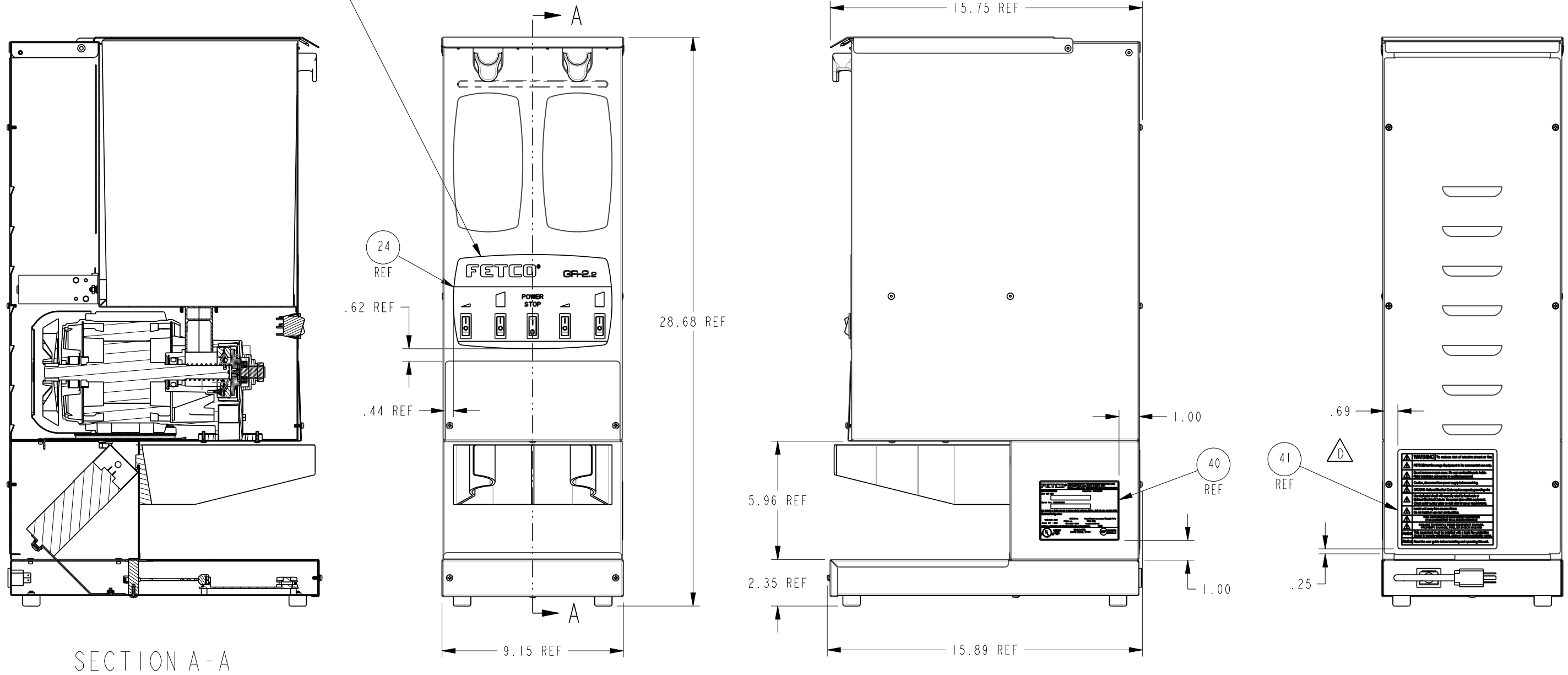

NOTE: POWER CORD NOT SHOWN

PROPRIETARY AND CONFIDENTIAL.  
THE INFORMATION CONTAINED IN THIS DRAWING IS THE SOLE PROPERTY OF FETCO.  
ANY REPRODUCTION IN PART OR AS A WHOLE WITHOUT THE WRITTEN PERMISSION OF FETCO IS PROHIBITED.

TOLERANCES		<b>FETCO</b> FOOD EQUIPMENT TECHNOLOGIES COMPANY	
UNLESS OTHERWISE SPECIFIED		600 ROSE ROAD, LAKE ZURICH, IL 60047, USA	
ALL DIMENSIONS IN INCHES		PHONE: (800) 338-2699 FAX: (847) 719-3001	
ALL DECIMAL ± .005" ANGULAR ± 1/2°		E-MAIL: engineering@fetco.com www.fetco.com	
THIRD-ANGLE		DRAWING NAME:	
THIRD-ANGLE		<b>GRINDER ASSEMBLY, GR-2.2, 120V</b>	
MATERIAL		CREATED BY:	DATE
N/A		DP	12/15/2009
	GAUGE	DRAWING BY:	SCALE
	N/A	DP	0.188
	FINISH	APP'D BY:	SHEETS
	N/A	AG	2 of 2
			REVISION
			<b>D</b>
			DRAWING NO.
			<b>1101.00033.00</b>