

NOTES:

1. DRAWING TO BE INTERPRETED IN ACCORDANCE WITH THE CURRENT REVISION OF ASME Y14.5M.
2. TSI TO BE INTERPRETED AS THEORETICAL SHARP INTERSECTION.
3. PARTS SHALL BE FREE OF ALL CONTAMINANTS INCLUDING GREASE, DIRT, MACHINING OIL AND OTHER CONTAMINANTS.
4. PARTS SHALL BE PACKAGE IN A MANNER TO PREVENT BOWING, SCRATCHING, OR OTHER DAMAGE DURING SHIPMENT

REVISIONS				
REV	DATE	ECO NO	DESCRIPTION	BY:
A	06/09/2015	N/A	ORIGINAL	DK

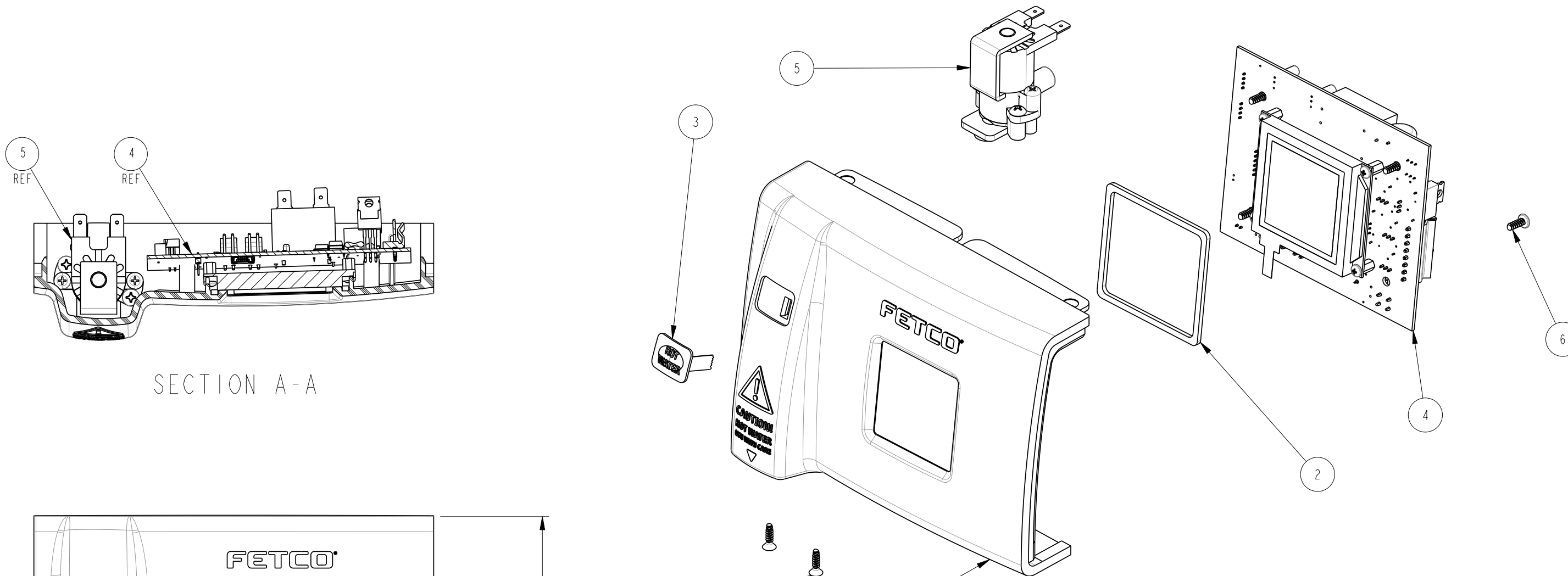

SECTION A-A

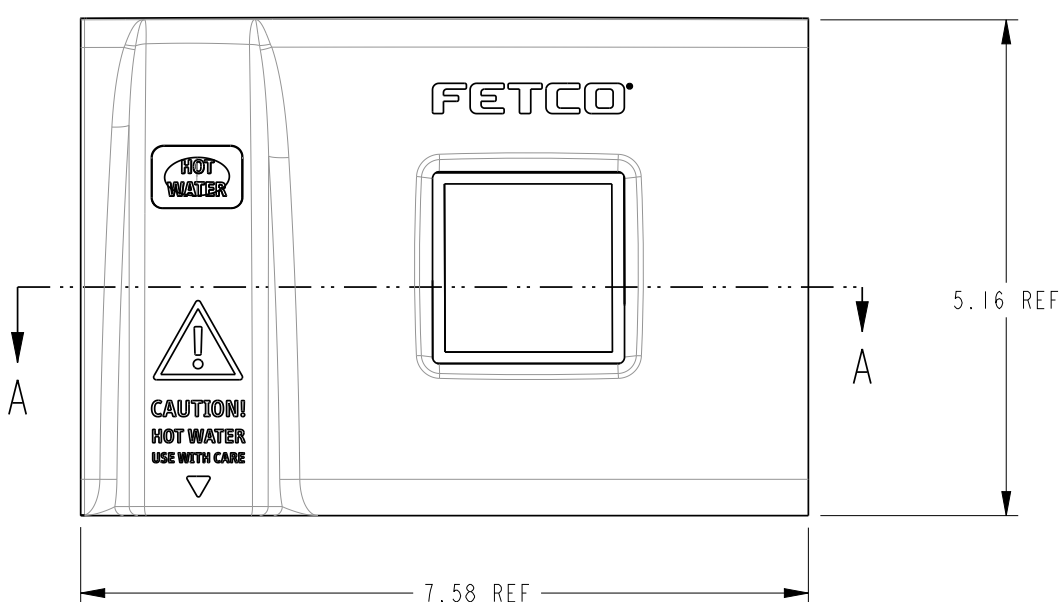

ITEM NO	QTY	PART NO	DESCRIPTION
7	2	1082.00109.00	SCREW, 6-19 x 1/2"L, FLAT HEAD THREAD FORMING
6	4	1082.00083.00	SCREW, #6-19 x 3/8", PAN HDTX, THRD FORM FOR PLASTIC, 18-8 SS
5	1	1102.00326.00	ASSEMBLY, HOT WATER DISPENSE VALVE, CBS-2121 AUTOMATIC
4	1	1102.00325.00	ASSEMBLY, TOUCH SCREEN, BOARD, CBS-2121 AUTOMATIC
3	1	1058.00043.00	MEMBRANE SWITCH, HOT WATER
2	1	1024.00085.00	GASKET, TOUCH DISPLAY, CBS-2121
1	1	1023.00258.00	FRONT PANEL, CBS-2121, COMBO

BILL OF MATERIALS			
TOLERANCES			
UNLESS OTHERWISE SPECIFIED			
ALL DIMENSIONS IN INCHES			
ALL DECIMAL ± .005" ANGULAR ± 1/2°			
THIRD-ANGLE			
MATERIAL N/A			
GAUGE N/A			
FINISH N/A			

FETCO FOOD EQUIPMENT TECHNOLOGIES COMPANY 600 ROSE ROAD, LAKE ZURICH, IL 60047, USA PHONE: (800) 338-2699 FAX: (847) 719-3001 E-MAIL: engineering@fetco.com www.fetco.com		
DRAWING NAME:		
ASS'Y. FRONT PANEL, CBS-2121, AUTO. POUR OVER		
CREATED BY:	DATE:	DRAWING NO.:
DK	06/09/2015	1102.00327.00
DRAWING BY:	SCALE:	REVISION:
E. FORONDA	0.500	A
APP'D BY:	SHEETS:	
SP	1 of 1	

PROPRIETARY AND CONFIDENTIAL. THE INFORMATION CONTAINED IN THIS DRAWING IS THE SOLE PROPERTY OF FETCO. ANY REPRODUCTION IN PART OR AS A WHOLE WITHOUT THE WRITTEN PERMISSION OF FETCO IS PROHIBITED.