

NOTES:

1. DRAWING TO BE INTERPRETED IN ACCORDANCE WITH THE CURRENT REVISION OF ASME Y14.5M.
2. TSI TO BE INTERPRETED AS THEORETICAL SHARP INTERSECTION.
3. PARTS SHALL BE FREE OF ALL CONTAMINANTS INCLUDING GREASE, DIRT, MACHINING OIL AND OTHER CONTAMINANTS.
4. PARTS SHALL BE PACKAGED IN A MANNER TO PREVENT SCRATCHING, BOWING OR OTHER DAMAGE DURING SHIPMENT.

REVISIONS

REV	DATE	ECO NO	DESCRIPTION	BY:	A
A	03/18/2015	N/A	ORIGINAL	DK	DK

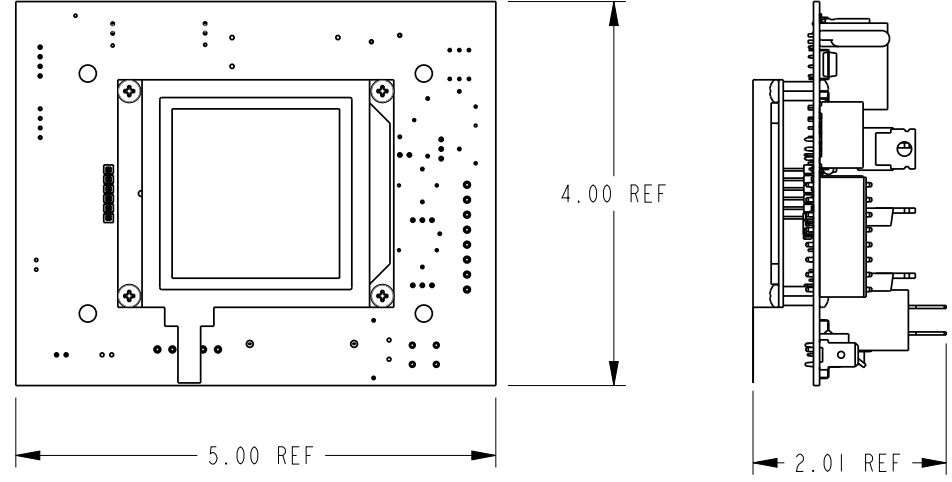
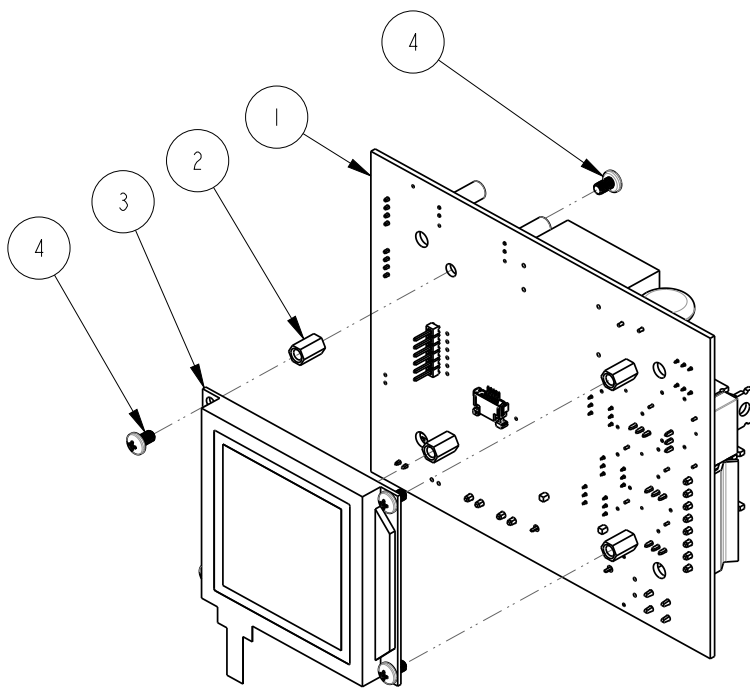

ITEM NO	QTY	PART NO	DESCRIPTION
4	8	1082.00061.00	SCREW M3-.5 X 5MM, PAN HD PH, MACHINE, 18-8 SS
3	1	1058.00042.00	DISPLAY, TOUCH SCREEN, CBS-2121
2	4	1084.00026.00	STANDOFF, M3-.5X8 MM FEM THRD, HEX NYLON
1	1	1051.00027.00	CONTROL BOARD, CBS-2121

BILL OF MATERIALS

<p>TOLERANCES UNLESS OTHERWISE SPECIFIED</p> <p>ALL DIMENSIONS IN INCHES</p> <p>ALL DECIMAL ± .005" ANGULAR ± 1/2°</p> <p>THIRD-ANGLE</p>	<p>FETCO FOOD EQUIPMENT TECHNOLOGIES COMPANY 600 ROSE ROAD, LAKE ZURICH, IL 60047, USA PHONE: (800) 338-2699 FAX: (847) 719-3001 E-MAIL: engineering@fetco.com www.fetco.com</p>		
	DRAWING NAME: ASS'Y., TOUCH SCREEN BOARD, CBS-2121, AUTO.		
	CREATED BY: DK	DATE 03/18/2015	DRAWING NO 1102.00325.00
	DRAWING BY: E. FORONDA	SCALE 0.500	REVISION A
MATERIAL N/A	GAUGE N/A	FINISH N/A	

PROPRIETARY AND CONFIDENTIAL. THE INFORMATION CONTAINED IN THIS DRAWING IS THE SOLE PROPERTY OF FETCO. ANY REPRODUCTION IN PART OR AS A WHOLE WITHOUT THE WRITTEN PERMISSION OF FETCO IS PROHIBITED.