

NOTES:

1. DRAWING TO BE INTERPRETED IN ACCORDANCE WITH THE CURRENT REVISION OF ASME Y14.5M.
2. TSI TO BE INTERPRETED AS THEORETICAL SHARP INTERSECTION
3. PARTS SHALL BE FREE OF ALL CONTAMINANTS INCLUDING GREASE, DIRT, MACHINING OIL AND OTHER CONTAMINANTS.
4. PARTS SHALL BE PACKAGED IN A MANNER TO PREVENT SCRATCHING, BOWING OR OTHER DAMAGE DURING SHIPMENT.

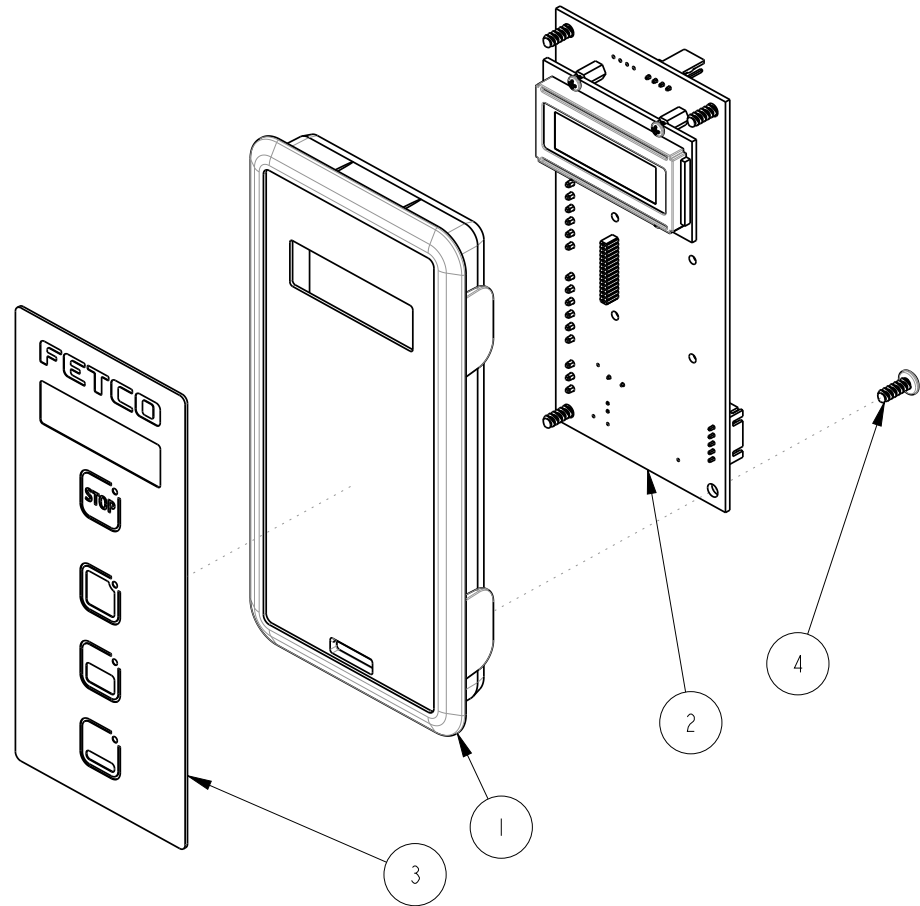

REVISIONS				
REV	DATE	ECO NO	DESCRIPTION	BY:
A	02/16/2017	N/A	ORIGINAL	DK

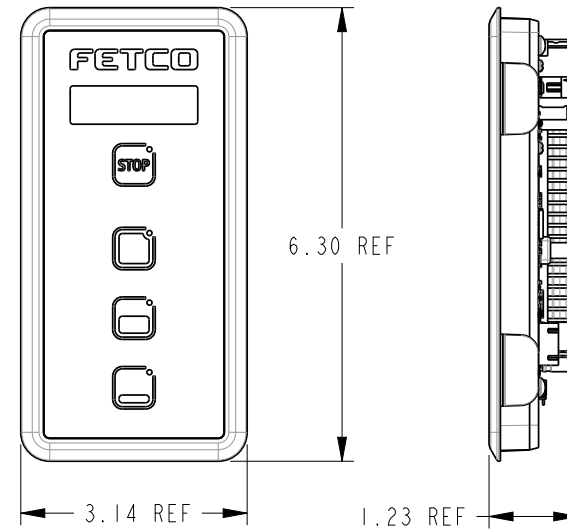

SCALE 0.375

ITEM NO	QTY	PART NO	DESCRIPTION
4	4	1082.00083.00	SCREW, #6-19 x 3/8", PAN HDTX, THRD FORM FOR PLASTIC, 18-8 SS
3	1	1058.00047.00	MEMBRANE SWITCH, CBS-1100 SERIES, SINGLE
2	1	1102.00371.00	ASSEMBLY, CONTROL BOARD, CBS-1100
1	1	1023.00290.00	FRONT PANEL, COVER

BILL OF MATERIALS			
TOLERANCES UNLESS OTHERWISE SPECIFIED		FETCO FOOD EQUIPMENT TECHNOLOGIES COMPANY 600 ROSE ROAD, LAKE ZURICH, IL 60047, USA PHONE: (800) 338-2699 FAX: (847) 719-3001 E-MAIL: engineering@fetco.com www.fetco.com	
ALL DIMENSIONS IN INCHES		DRAWING NAME: ASSEMBLY, FRONT PANEL, CBS-1100 SINGLE	
ALL DECIMAL ± .005" ANGULAR ± 1/2°		CREATED BY: DK	DATE 02/16/2017
THIRD-ANGLE		DRAWING BY: DK	SCALE 0.500
		APP'D BY: AG	SHEETS 1 of 1
MATERIAL N/A		GAUGE N/A	FINISH N/A
		DRAWING NO 1102.00375.00	
		REVISION A	

PROPRIETARY AND CONFIDENTIAL.
 THE INFORMATION CONTAINED IN THIS DRAWING IS THE SOLE PROPERTY OF FETCO.
 ANY REPRODUCTION IN PART OR AS A WHOLE WITHOUT THE WRITTEN PERMISSION OF FETCO IS PROHIBITED.