

NOTES:

1. DRAWING TO BE INTERPRETED IN ACCORDANCE WITH THE CURRENT REVISION OF ASME Y14.5M.
2. TSI TO BE INTERPRETED AS THEORETICAL SHARP INTERSECTION
3. PARTS SHALL BE FREE OF ALL CONTAMINANTS INCLUDING GREASE, DIRT, MACHINING OIL AND OTHER CONTAMINANTS.
4. PARTS SHALL BE PACKAGED IN A MANNER TO PREVENT SCRATCHING, BOWING OR OTHER DAMAGE DURING SHIPMENT.

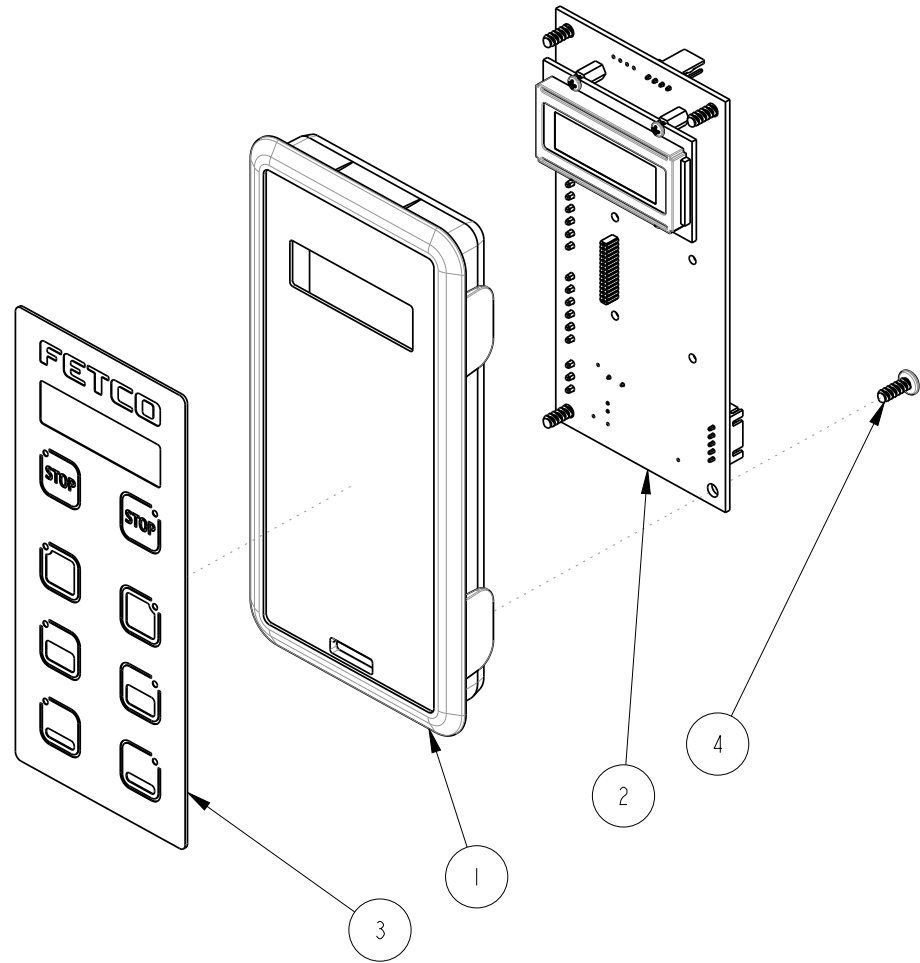

REVISIONS				
REV	DATE	ECO NO	DESCRIPTION	BY:
A	08/23/2016	N/A	ORIGINAL	DK

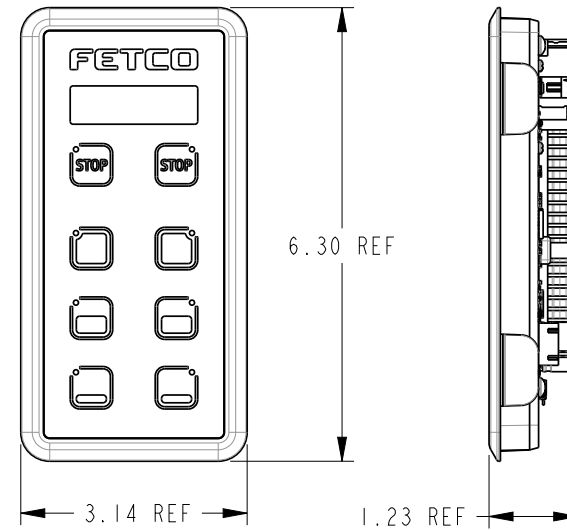

SCALE 0.375

ITEM NO	QTY	PART NO	DESCRIPTION
4	4	1082.00083.00	SCREW, #6-19 x 3/8", PAN HDTX, THRD FORM FOR PLASTIC, 18-8 SS
3	1	1058.00048.00	MEMBRANE SWITCH, CBS-1100 SERIES, DUAL
2	1	1102.00371.00	ASSEMBLY, CONTROL BOARD, CBS-1100
1	1	1023.00290.00	FRONT PANEL, COVER

BILL OF MATERIALS

TOLERANCES UNLESS OTHERWISE SPECIFIED	<b>FETCO</b> FOOD EQUIPMENT TECHNOLOGIES COMPANY 600 ROSE ROAD, LAKE ZURICH, IL 60047, USA PHONE: (800) 338-2699 FAX: (847) 719-3001 E-MAIL: engineering@fetco.com www.fetco.com		
	DRAWING NAME: <b>ASSEMBLY, FRONT PANEL, CBS-1100 DUAL</b>		
ALL DIMENSIONS IN INCHES	CREATED BY: DK	DATE 08/23/2016	DRAWING NO <b>1102.00372.00</b>
	DRAWING BY: E. FORONDA	SCALE 0.500	REVISION <b>A</b>
ALL DECIMAL ± .005" ANGULAR ± 1/2°	APP'D BY: AG	SHEETS 1 of 1	
THIRD-ANGLE	MATERIAL N/A	GAUGE N/A	FINISH N/A

PROPRIETARY AND CONFIDENTIAL.  
 THE INFORMATION CONTAINED IN THIS DRAWING IS THE SOLE PROPERTY OF FETCO.  
 ANY REPRODUCTION IN PART OR AS A WHOLE WITHOUT THE WRITTEN PERMISSION OF FETCO IS PROHIBITED.