

NOTES:

1. CHANGE OF MATERIAL IS NOT PERMITTED UNLESS APPROVED IN WRITING BY FETCO ENGINEERING PERSONNEL.
2. DRAWING TO BE INTERPRETED IN ACCORDANCE WITH THE CURRENT REVISION OF ASME Y14.5M.
3. TSI TO BE INTERPRETED AS THEORETICAL SHARP INTERSECTION.
4. PARTS SHALL BE FREE OF ALL CONTAMINANTS INCLUDING GREASE, DIRT, MACHINING OIL AND OTHER CONTAMINANTS.
5. PARTS SHALL BE PACKAGED IN A MANNER TO PREVENT SCRATCHING, BOWING OR OTHER DAMAGE DURING SHIPMENT.



SCALE 1.000

REVISIONS

REV	DATE	ECO NO	DESCRIPTION	BY:	A
A	10/24/2016	N/A	ORIGINAL	AG	

DATA TABLE

FETCO PART NO.	VENDOR	VENDOR PART NO.	MATERIAL	DIMENSIONS					
				"A"	"B"	"C"	"D"	"THREAD"	"LENGTH"
1082.00083.00	McMASTER-CARR	96001A260	18-8 ST. STL.	.270	.097	.147	T15	#6-19	.375
1082.00090.00		99512A459	ZINC-PLATED	.373	.133	.212	T25	#10-14	1.000
1082.00117.00		96001A264	18-8 ST. STL.	.270	.097	.147	T15	#6-19	.500

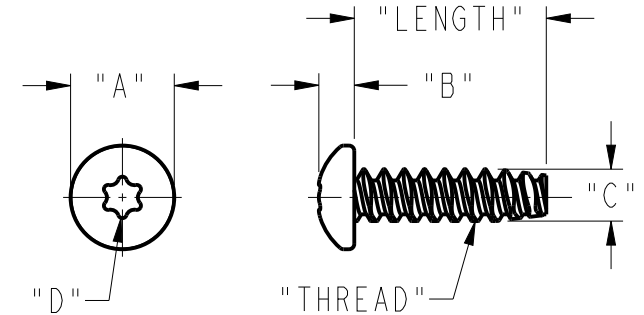

PROPRIETARY AND CONFIDENTIAL.  
 THE INFORMATION CONTAINED IN THIS DRAWING IS THE SOLE PROPERTY OF FETCO.  
 ANY REPRODUCTION IN PART OR AS A WHOLE WITHOUT THE WRITTEN PERMISSION OF FETCO IS PROHIBITED.

TOLERANCES UNLESS OTHERWISE SPECIFIED		<b>FETCO</b> <sup>®</sup> FOOD EQUIPMENT TECHNOLOGIES COMPANY 600 ROSE ROAD, LAKE ZURICH, IL 60047, USA PHONE: (800) 338-2699 FAX: (847) 719-3001 E-MAIL: engineering@fetco.com www.fetco.com	
ALL DIMENSIONS IN INCHES		DRAWING NAME: <b>SCREW # 6-19 X 3/8", P/H/TX, THRD FORM FOR PLASTIC, 18-8 SS</b>	
ALL DECIMAL ± .005" ANGULAR ± 1/2°		CREATED BY: AG	DATE 10/24/2016
THIRD-ANGLE		DRAWING BY: E. FORONDA	SCALE 2.000
		APP'D BY: AS	SHEETS 1 of 1
MATERIAL PURCHASED		DRAWING NO <b>1082.00083.00</b>	
		REVISION <b>A</b>	
		GAUGE N/A	
		FINISH N/A	